

WayFinding Sign

Product Parts

1. Bracket
2. Quick Release Band (x2)
3. Bolt (x2)
4. Nut (x2)
5. Graphic Sign

NOTE: Graphic Sign can be a rectangle or arrow shape

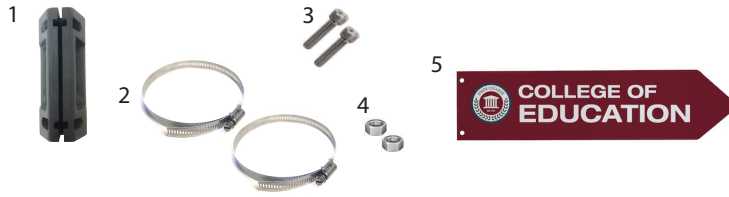

Display Set-up

Step 1

Insert Graphic Sign (5) into Bracket (1) making sure the holes in the Graphic Sign (5) align with the holes in the Bracket (1)

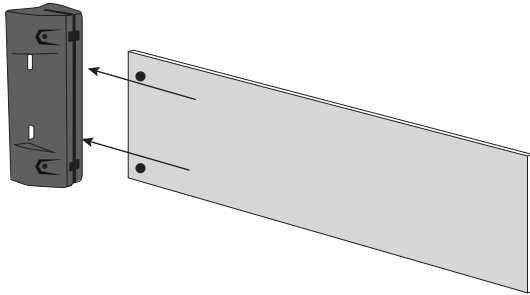

Step 2

Insert Bolts (3) through the screw holes on the bracket. Tighten Nuts (4) onto Bolts (3) to secure Bracket (1) and Graphic Sign (5).

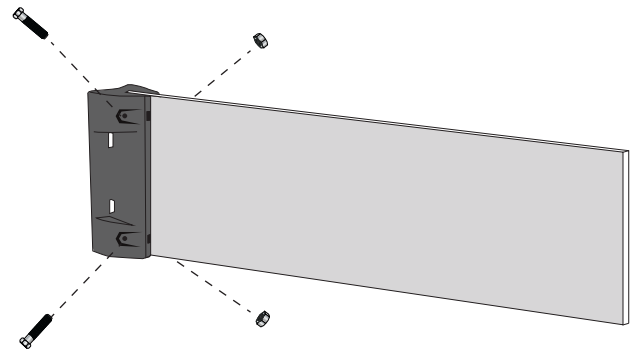

Step 3

Slide Quick Release Band (2) through slots on Bracket (1). Repeat for other Quick Release Band (2).



Step 4

Secure the Bracket (1) to a pole with two Quick Release Bands (2). Tighten the bands by turning the bolt with a screwdriver until snug on pole. Be sure the band head is on the pole and not on the bracket. Clip off any excess band length.

